

MOBEX P-36

(09.832)

Mains voltage	(V)	400	Filter surface	(m ²)	36
Nominal power	(kW)	4,0	Filter quantity	(pc)	3
Mains frequency	(Hz)	50	Cleaning type		Jet Pulse
Circuit breaker	(A)	C16	Collection volume	(liter)	2 x 38
Nominal current	(A)	9,0	Dimensions (L x B x H)	(mm)	2.030 x 1.040 x 2.030
Max. volume flow	(m ³ /h)	4.500	Weight	(kg)	approx. 330
Max. neg. pressure	(Pa)	3.400	Comp. air consumption* (l/impuls)		approx. 19
Intake opening	(mm)	250	Comp. air connection	(bar)	4 - 6
Sound pressure level	LpA(dBA)	74	* with 4 bar and valve opening time of 0,12sec		

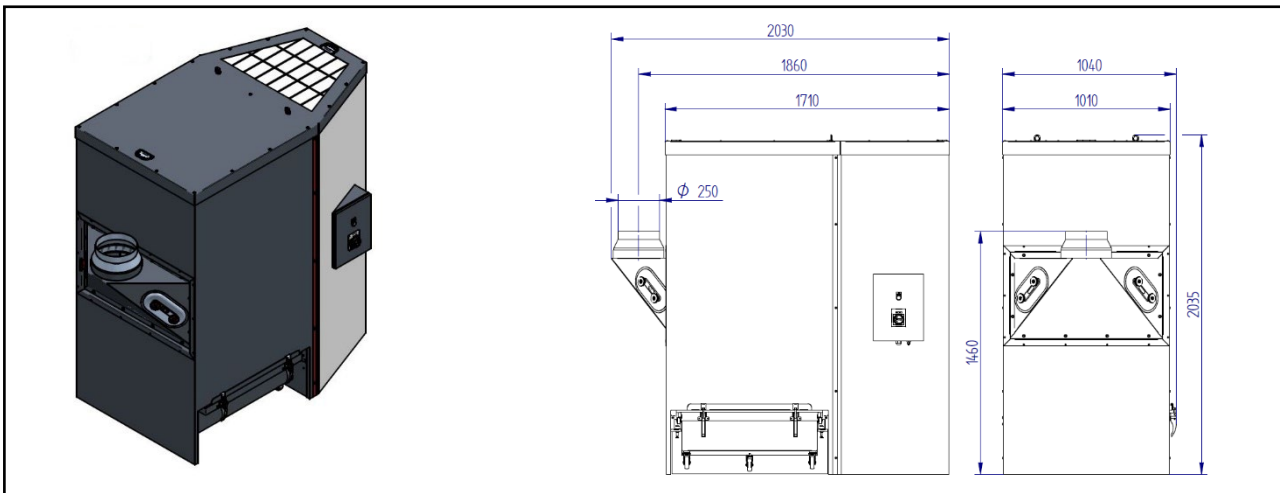

ESTA PLUS

Application range:

- Single and multiple extraction in industrial plants or smaller workshops
- Pourable and dry dusts and chips

Your benefits at a glance:

- All-purpose for dusts and chips
- Tight and powerful
- Convenient dust disposal
- Low operation noise
- Low operating costs
- Test certificates for special applications

Characteristics:

- Automatic jet pulse filter cleaning system
- Cleanable long life cartridge filters (dust classification M)
- Integrated impact separator
- Easy replaceable dust collection bins
- New housing structure of sandwich panel

Modifications:

- Mobile on wheels (H + 107 mm)
- ATEX-version
- With postfilter cartridge (dust classification H)
- With dry contact for external control
- Test certificate W3 for extraction of stainless welding fumes

State of the art: 09832-51-04 Subject to change without notice! For remaining questions please do not hesitate to contact us.

ESTA Apparatebau GmbH & Co. KG
Gotenstraße 2 – 6
89250 Senden / GERMANY

Phone +49 7307 804-0
Fax +49 7307 804-500
E-Mail info@esta.com

www.esta.com